



2A MEOPHAM ROAD MITCHAM, CR4 1BG

£1,250 PER MONTH

*** FANTASTIC ONE DOUBLE BEDROOM SEMI DETACHED HOUSE NEAR TO TRANSPORT LINKS ***

A one bedroom semi-detached property situated on Meopham Road which can be accessed via Grove Road on the Mitcham/Streatham borders and benefitting from gas central heating, double glazing, modern kitchen and bathroom, downstairs WC.

Please note: Photos used are for reference and were taken prior to previous tenants' occupancy

Council Tax: Band C - London Borough of Merton - 2025/2026: £1,856.38 (2026/2027 figures not yet available)



TOOMEY
ESTATE AGENTS

GROUND FLOOR
241 sq.ft. (22.4 sq.m.) approx.

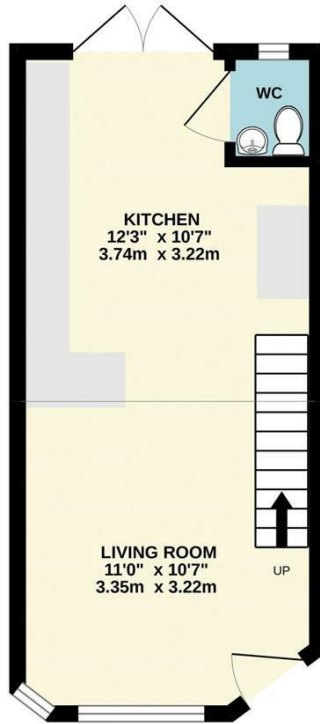

1ST FLOOR
198 sq.ft. (18.4 sq.m.) approx.

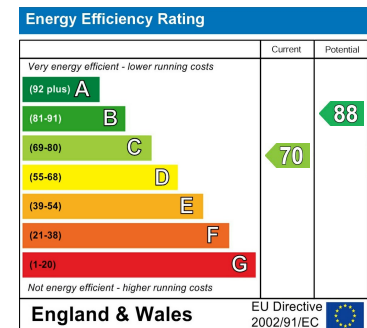
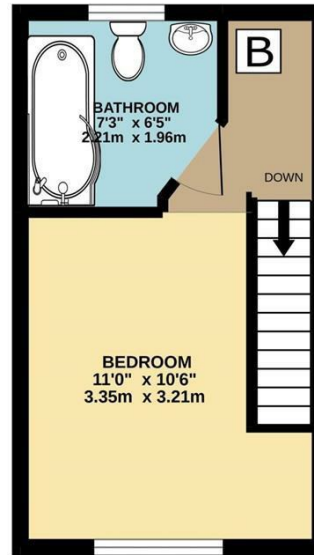

Agents Note: Whilst every care has been taken to prepare these particulars, they are for guidance purposes only. All measurements are approximate and are for general guidance purposes only and whilst every care has been taken to ensure their accuracy, they should not be relied upon and potential buyers/tenants are advised to recheck the measurements

Toomey Estate Agents Sales
333a London Road
Mitcham
Surrey
CR4 4BE

0208 715 9333
enquiries@toomeyestateagents.co.uk
www.toomeyestateagents.co.uk



TOOMEY
ESTATE AGENTS